

NHSSCOTLAND PROJECT FACT FILE

Health Facility Project Name	Whinhill Medical Practice
Location	Whinhill Road Aberdeen AB11 7 XH
Population served	6853 (Practice Population)
Type of healthcare facility	Primary care medical centre with integral police station
Type of construction	New Build
Construction start date (estimated or actual)	February 2010 Actual
Construction completion date	November 2010 Actual
Gross floor area (m²)	883m ²
Project, design and construction cost	<p>Construction cost (incl all design fees, risk, survey fees, planning & warrant, overheads & profit etc) £2,606,778</p> <p>Board fees and expenses £103,153</p> <p>Land purchase & legal fees £957,000</p> <p>Equipment and other costs £60,306</p> <p>VAT *1 £483,896</p> <p>TOTAL *2 £4,211,133</p> <p>*note 1 – VAT only applicable on certain items *note 2 – Total cost includes Police contribution towards cost of the police station</p>
Cost per m²	£2952m ² based on full cost of construction including design fees etc but excluding VAT
Total bed numbers	Not applicable
Departmental information	<p>Police Station with its own separate entrance and facilities i.e. reception, toilets, mess etc</p> <p>Within the medical centre as follows:</p> <ul style="list-style-type: none"> • 4 Consulting rooms for 1 merged GP practice (previously 2 separate practices)

	<ul style="list-style-type: none"> • Admin, practice manager and office space etc • GP training room • Minor procedures room • Multipurpose room (baby clinics, immunisation and ante natal classes) • Community nurse office for 6 persons • Social work office for 3 persons
Client/owner	NHS Grampian and Grampian Police http://www.nhsgrampian.org
Project Manager/Key contact(s)	<p><u>Project Manager</u> Stan Mathieson NHS Grampian Property and Asset Management Summerfield House 2 Eday Road Aberdeen AB15 6RE Stan.mathieson@nhs.net Tel 01224 558687 Mob 07500033753</p> <p><u>Project Director</u> Jackie Bremner NHS Grampian Modernisation Directorate Summerfield House 2 Eday Road Aberdeen AB15 6RE Jackie.bremner@nhs.net Tel 01224 558548</p>
Capital procurement route	Capital Public funding with recharge to Grampian Police
Project management	<u>PSC appointment</u> Davis Langdon 7 th Floor Aurora 120 Bothwell Street Glasgow G2 7JS
Architects	Supply chain Architect (through Framework contractor) Halliday Fraser and Munro Carden Church 6 Carden Place Aberdeen AB10 1UR

Contractor	Morrison Construction Scotland (North East) Morrison House Kingseat Business Park Newmachar Aberdeenshire AB21 OAZ
Services	See Departmental information
Key facts	<p>This project is believed to be the first healthcare facility of its kind to achieve BREEAM excellent.</p> <p>This project is believed to be the first completed project using the HFS Framework, accepting of course that a number of pilot projects were commissioned and completed beforehand.</p> <p>The project was delivered below the target price and within the target timescale</p> <p>The project was significant in terms of partnership/joint working between NHS Grampian and Grampian Police and includes 2 distinct services co-located within the same premises</p>

LEGEND

- ▨ CHP/GP/SOC SER SHARED = 122.30m²
- ▨ CHP DEDICATED = 9.83m²
- ▩ COMMUNAL = 8.55m²
- ▨ GP DEDICATED = 216.97m²
- ▩ CHP/GP SHARED = 34.71m²
- INTERNAL PARTITIONS = 60.33m²

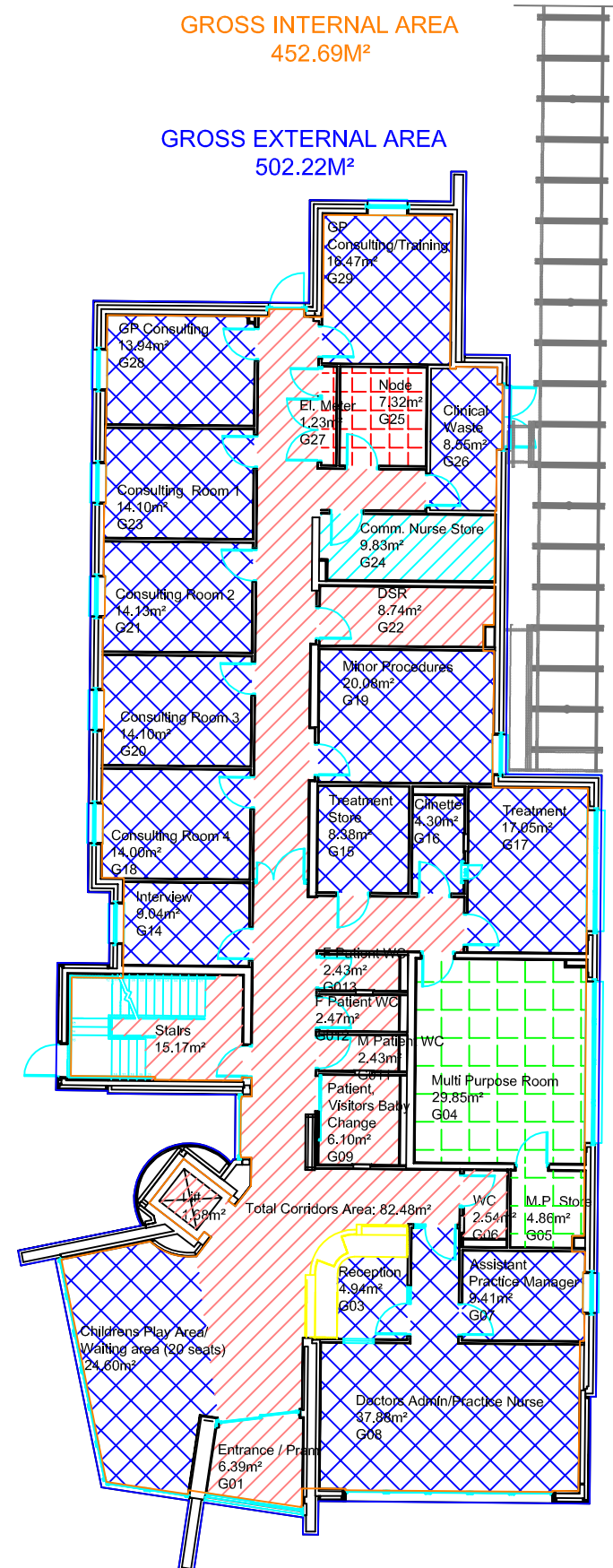

NHS Grampian

National Health Service
Physical Planning Team
Summerfield House
2 Eday Road
Aberdeen AB15 6RE
Tel: 01224 558620
Fax: 01224 558686

Location/Site:

WHINHILL HEALTH CENTRE
WHINHILL ROAD
ABERDEEN

Drawing Title:

Ground Floor Plan

Drawing No: n/a	
Drawn By: n/a	Scale: 1:200
Checked By: n/a	Date: JAN 2012

LEGEND

- CHP/GP/SOC SER SHARED = 130.71m²
- CHP DEDICATED = 27.39m²
- POLICE = 101.32m²
- COMMUNAL = 15.68m²
- GP DEDICATED = 92.39m²
- SOCIAL SERVICES = 16.49m²
- INTERNAL PARTITIONS = 39.73m²

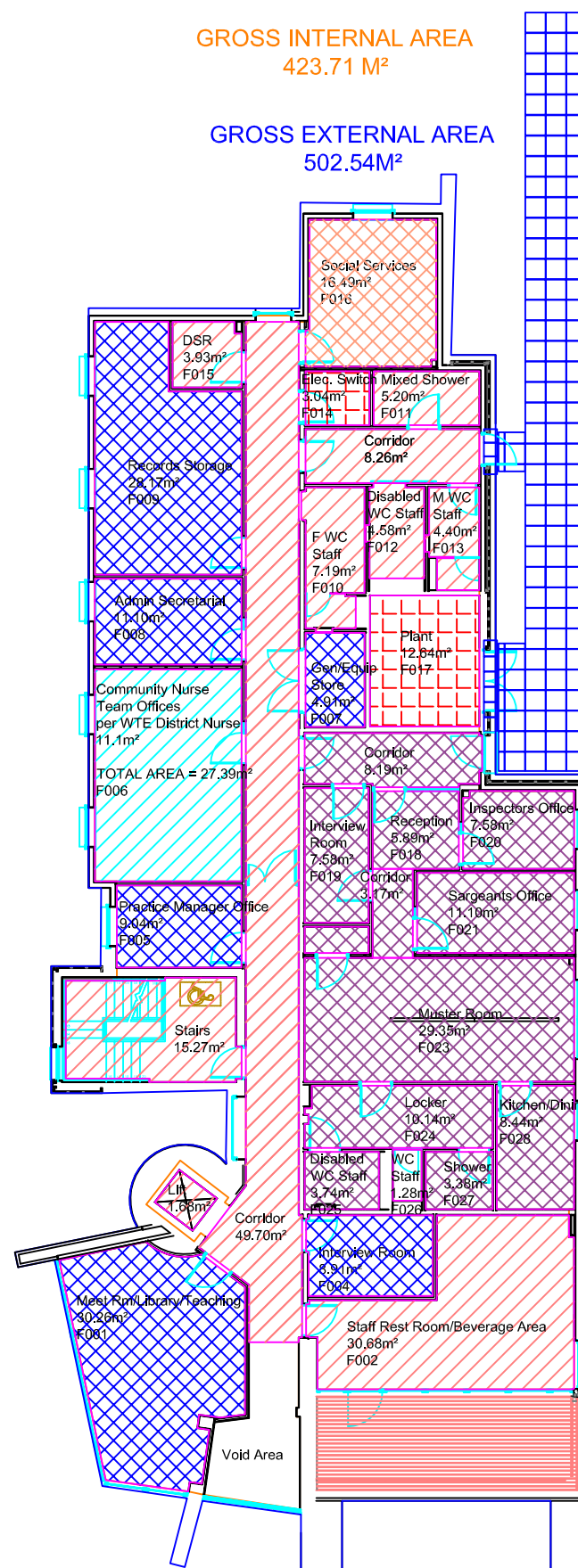

NHS Grampian

National Health Service
Physical Planning Team
Summerfield House
2 Eday Road
Aberdeen AB15 6RE
Tel: 01224 558620
Fax: 01224 558686

Location/Site:

WHINHILL HEALTH CENTRE
WHINHILL ROAD
ABERDEEN

Drawing Title:

First Floor Plan

Drawing No: n/a

Drawn By: n/a

Scale: 1:200

Checked By: n/a

Date: MAR 2012